

# SGI-SGP SERIES

GEARLESS MACHINES

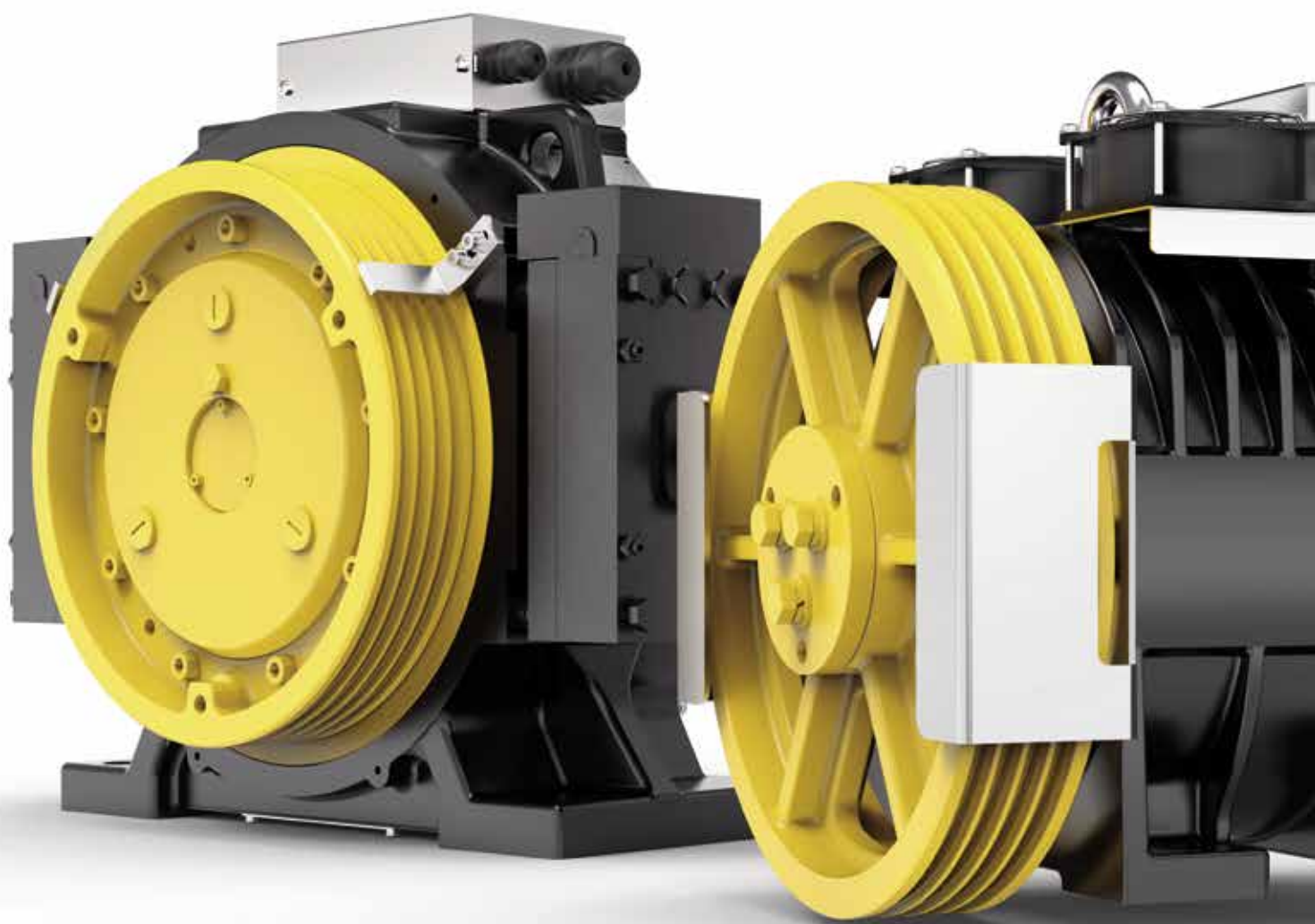



Understanding the market,  
anticipating its needs,  
making them ours and  
building our projects on them.



# Development history

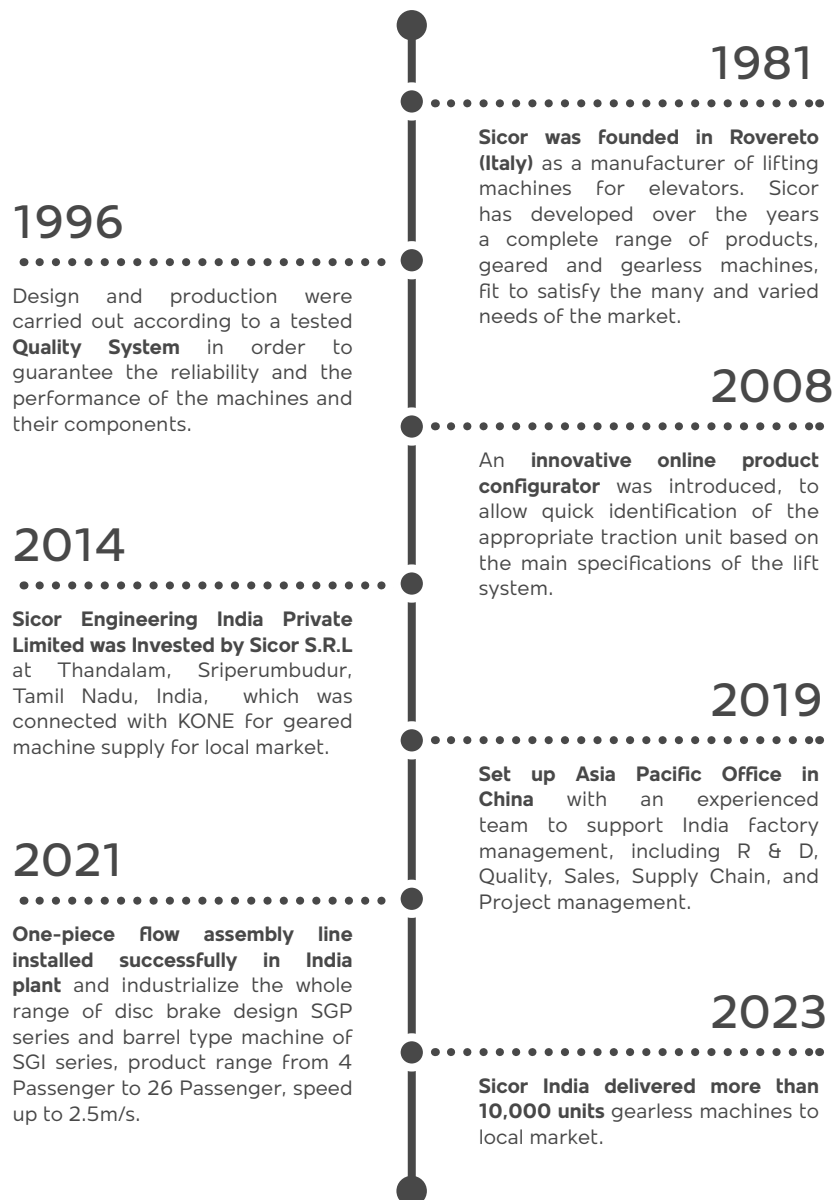

## Our product range at a glance

### SGI















Model	Capacity	Car Speed Range (2:1)	Max. Static Load
	[kg]	[m/s]	[kg]
<b>SGIH04</b>	<b>272</b>	0.32~0.6	1150
<b>SGI06-A</b>	<b>408</b>	0.5 ~1.0	1150, 1800
<b>SGI06-B</b>	<b>408</b>	1.5	1800
<b>SGI08-B</b>	<b>544</b>	1.0 ~1.75	1800
<b>SGI10-N</b>	<b>680</b>	1.0 ~1.75	2000
<b>SGI13-N</b>	<b>884</b>	1.0 ~1.75	2500
<b>SGI15-N</b>	<b>1020</b>	1.0 ~1.75	3000, 2500

### SGP

Model	Capacity	Car Speed Range (2:1)	Max. Static Load
	[kg]	[m/s]	[kg]
<b>SGP06</b>	<b>408</b>	1.0 ~1.75	1600
<b>SGP06</b>	<b>408</b>	2.0	2000
<b>SGP08</b>	<b>544</b>	1.0~1.75	1600
<b>SGP08</b>	<b>544</b>	2.0	2000
<b>SGP10</b>	<b>680</b>	1.0~2.0	2000
<b>SGP13</b>	<b>884</b>	1.0~2.5	3000
<b>SGP16</b>	<b>1088</b>	1.0~2.5	3000
<b>SGP20</b>	<b>1360</b>	1.0~2.5	4500
<b>SGP24</b>	<b>1632</b>	1.0~2.5	4500
<b>SGP26</b>	<b>1768</b>	1.0~1.75	5000

# Capacity and Speed

Roping 2:1

		Capacity [kg]	Speed [m/s]							
			0.32	0.50	0.60	1.00	1.50	1.75	2.00	2.50
SGP26		1,768				■	■	■	■	
SGP24		1,632				■	■	■	■	■
SGP20		1,360				■	■	■	■	■
SGP16		1,088				■	■	■	■	■
SGI15-N		1,020				■	■	■		
SGP13		884				■	■	■	■	■
SGI13-N						■	■	■		
SGP10		680				■	■	■	■	
SGI10-N						■	■	■		
SGP08		544				■	■	■	■	
SGI08-B						■	■	■		
SGP06		408				■	■	■	■	
SGI06-B							■	■		
SGI06-A					■	■	■			
SGIH04		272	■	■	■					

The Sicor India gearless production range allows applications for load capacities up to 1.768 kg in 2:1 suspension, speeds up to 2.5m/s with traction sheaves from 240 to 480mm. Numerous customized executions and options are available on request.



# “GEARLESS SGI”

<b>SGIH04</b>	p.8
<b>SGI06-A</b>	p.9/11
<b>SGI06-B</b>	p.12
<b>SGI08-B</b>	p.13/14
<b>SGI10-N</b>	p.15
<b>SGI13-N</b>	p.16
<b>SGI15-N</b>	p.17



# SGIH04

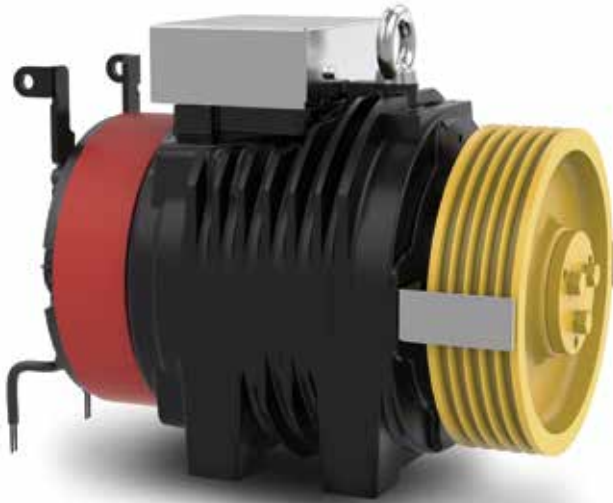

Brake Torque **2x250 Nm**  
 Brake Voltage **DC110V**  
 Roping **2:1**  
 Work Duty **S5-40%**  
 Wrapping **Single wrap**  
 CTW **50%**  
 Encoder **SinCos, PPR-2048, Voltage-5Vdc**  
 Insulation Class **F**  
 Protection Grade **IP40**

## SAMPLE CONFIGURATION TABLE

Model	Capacity	Elevator Speed	Rated Output	Rated voltage	Rated current	Rated speed	Frequency	Sheave Diameter	Poles	Torque	Ropes	Groove Dist	Shaft Load	Weight
	[kg]	[m/s]	[kW]	[V]	[A]	[rpm]	[Hz]	[mm]	[2p]	[Nm]		[mm]	[kg]	[kg]
<b>SGIH 04-050</b>	272	0.50	0.86	208	5.5	96	16.0	200	20	86	4-Φ6	10	1,150	125
<b>SGIH 04-060</b>	272	0.60	1.03	208	6.5	96	16.0	240	20	103	4-Φ6	10	1,150	130
<b>SGIH 04-060</b>	272	0.60	1.03	208	6.5	96	16.0	240	20	103	4-Φ8	12	1,150	130

## DIMENSIONS

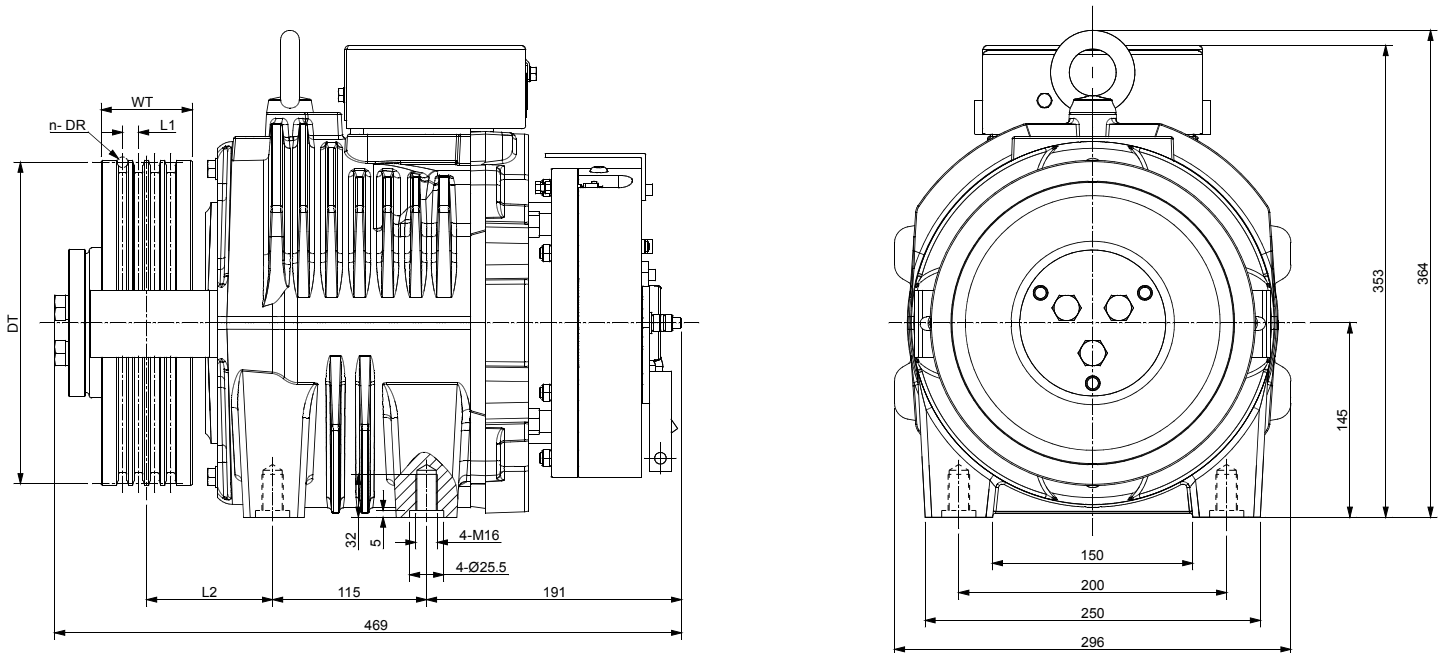

MODEL	DT	n-DR	WT	L1	L2
SGI H04 200	200	4-Ø6	50	10	85
SGI H04 240	240	4-Ø6	68	10	94
SGI H04 240	240	4-Ø8	68	12	94



# SGI06-A



Sheave Diameter **200 mm**  
 Brake Torque **2x250 Nm**  
 Brake Voltage **DC110V**  
 Roping **2:1**  
 Work Duty **S5-40%**  
 Wrapping **Single wrap**  
 CTW **50%**  
 Encoder **SinCos, PPR-2048, Voltage-5Vdc**  
 Insulation Class **F**  
 Protection Grade **IP40**

## SAMPLE CONFIGURATION TABLE

Model	Capacity	Elevator Speed	Rated Output	Rated voltage	Rated current	Rated speed	Frequency	Sheave Diameter	Poles	Torque	Ropes	Groove Dist	Shaft Load	Weight
	[kg]	[m/s]	[kW]	[V]	[A]	[rpm]	[Hz]	[mm]	[2p]	[Nm]		[mm]	[kg]	[kg]
<b>SGI 06-050-A</b>	408	0.50	1.28	208	8.0	96	12.8	200	16	127	4-Φ6	10	1,150	120
<b>SGI 06-050-A</b>	408	0.50	1.28	360	8.0	96	12.8	200	16	127	4-Φ6	10	1,150	120
<b>SGI 06-100-A</b>	408	1.00	2.54	360	8.0	191	25.5	200	16	127	4-Φ6	10	1,150	120

## DIMENSIONS

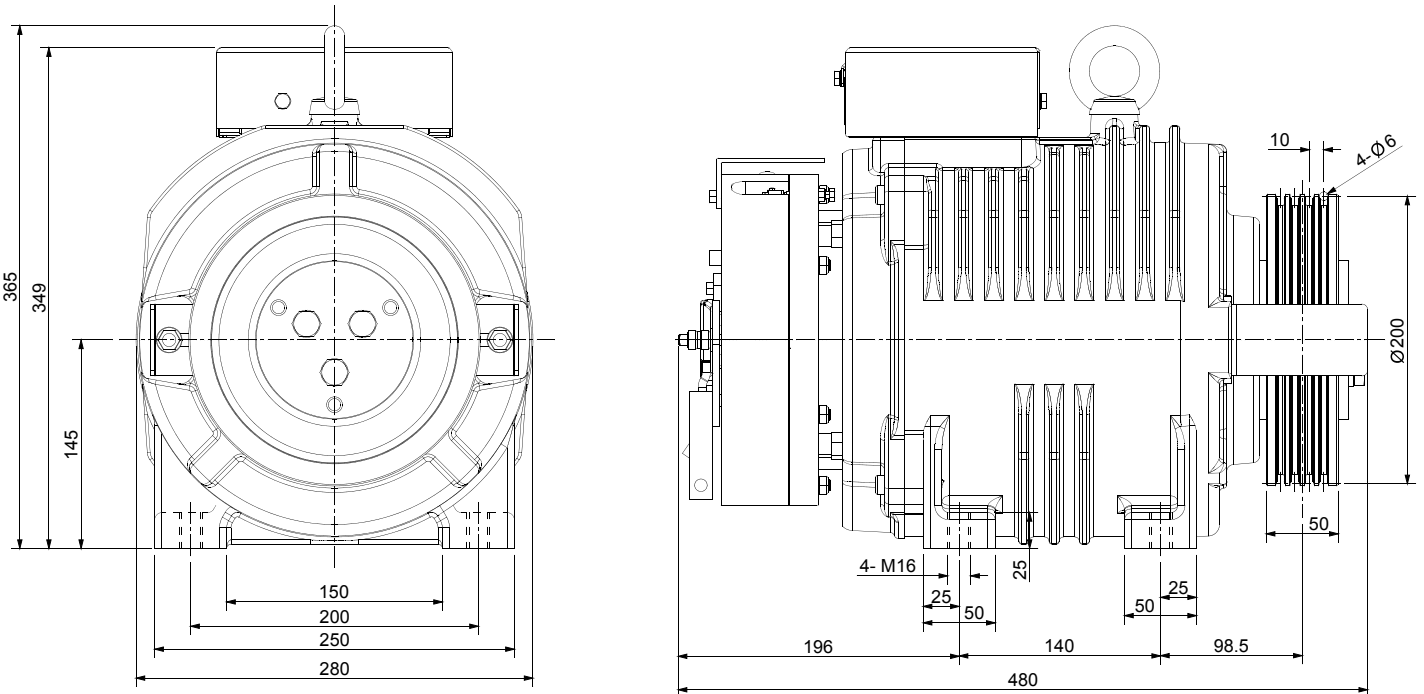

# SGI06-A



Sheave Diameter **240 mm**  
 Brake Torque **2x250 Nm**  
 Brake Voltage **DC110V**  
 Roping **2:1**  
 Work Duty **S5-40%**  
 Wrapping **Single wrap**  
 CTW **50%**  
 Encoder **SinCos, PPR-2048, Voltage-5Vdc**  
 Insulation Class **F**  
 Protection Grade **IP40**

## SAMPLE CONFIGURATION TABLE

Model	Capacity	Elevator Speed	Rated Output	Rated voltage	Rated current	Rated speed	Frequency	Sheave Diameter	Poles	Torque	Ropes	Groove Dist	Shaft Load	Weight
	[kg]	[m/s]	[kW]	[V]	[A]	[rpm]	[Hz]	[mm]	[2p]	[Nm]		[mm]	[kg]	[kg]
<b>SGI 06-050-A</b>	408	0.50	1.32	208	8.0	80	10.7	240	16	157	4-Φ8	12	1,150	120
<b>SGI 06-100-A</b>	408	1.00	2.64	360	8.0	160	21.3	240	16	157	4-Φ8	12	1,150	120

## DIMENSIONS

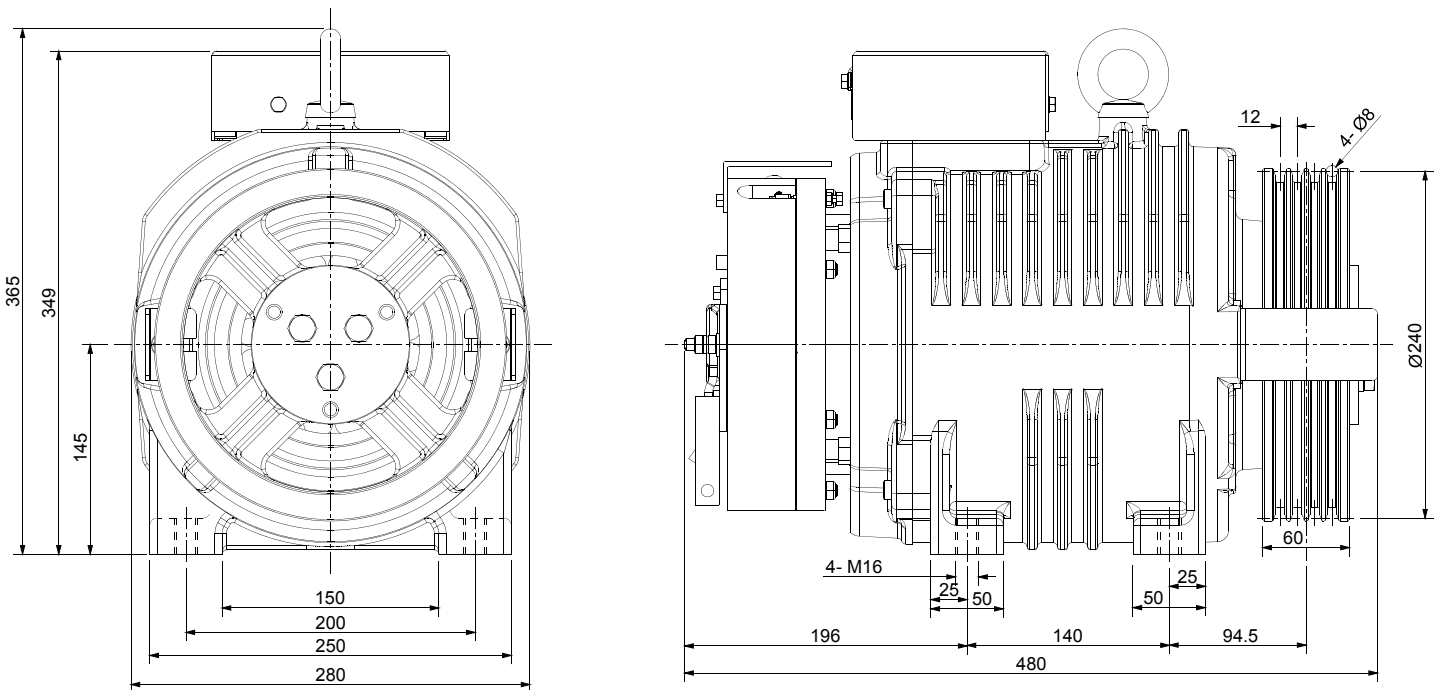

# SGI06-A



Sheave Diameter **320 mm**  
 Brake Torque **2x250 Nm**  
 Brake Voltage **DC110V**  
 Roping **2:1**  
 Work Duty **S5-40%**  
 Wrapping **Single wrap**  
 CTW **50%**  
 Encoder **SinCos, PPR-2048, Voltage-5Vdc**  
 Insulation Class **F**  
 Protection Grade **IP40**

## SAMPLE CONFIGURATION TABLE

Model	Capacity	Elevator Speed	Rated Output	Rated voltage	Rated current	Rated speed	Frequency	Sheave Diameter	Poles	Torque	Ropes	Groove Dist	Shaft Load	Weight
	[kg]	[m/s]	[kW]	[V]	[A]	[rpm]	[Hz]	[mm]	[2p]	[Nm]		[mm]	[kg]	[kg]
<b>SGI 06-050-A</b>	408	0.50	1.32	208	8.0	60	8.0	320	16	210	4-Φ8	12	1,800	125
<b>SGI 06-100-A</b>	408	1.00	2.64	360	8.0	120	16.0	320	16	210	4-Φ8	12	1,800	125

## DIMENSIONS

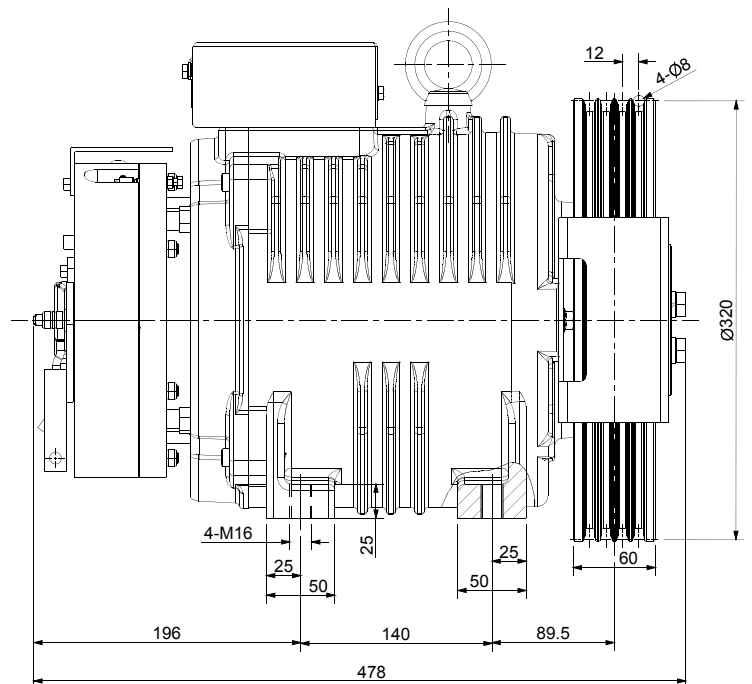
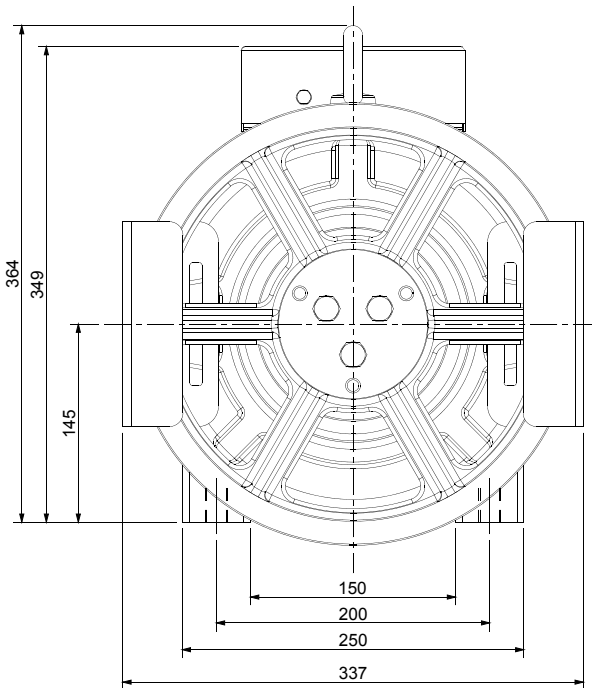

# SGI06-B



Sheave Diameter **320 mm**  
 Brake Torque **2x250 Nm**  
 Brake Voltage **DC110V**  
 Roping **2:1**  
 Work Duty **S5-40%**  
 Wrapping **Single wrap**  
 CTW **50%**  
 Encoder **SinCos, PPR-2048, Voltage-5Vdc**  
 Insulation Class **F**  
 Protection Grade **IP40**

## SAMPLE CONFIGURATION TABLE

Model	Capacity	Elevator Speed	Rated Output	Rated voltage	Rated current	Rated speed	Frequency	Sheave Diameter	Poles	Torque	Ropes	Groove Dist	Shaft Load	Weight
	[kg]	[m/s]	[kW]	[V]	[A]	[rpm]	[Hz]	[mm]	[2p]	[Nm]		[mm]	[kg]	[kg]
<b>SGI 06-150-B</b>	408	1.50	3.94	360	12.0	179	23.9	320	16	210	4-Φ8	12	1,800	120

## DIMENSIONS

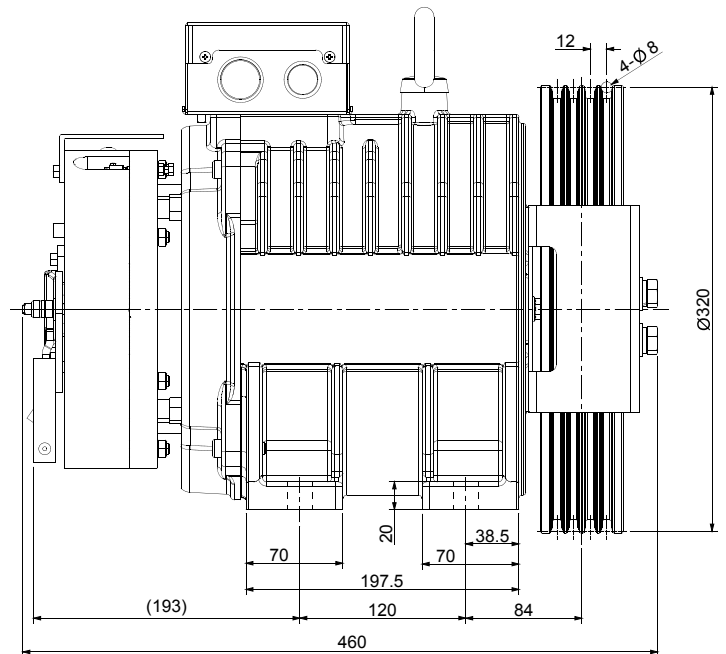
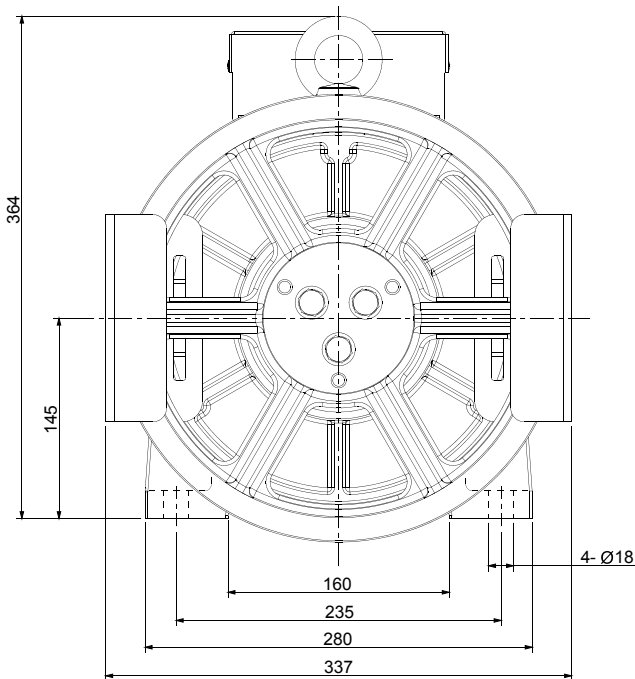

# SGI08-B



Sheave Diameter **240 mm**  
 Brake Torque **2x250 Nm**  
 Brake Voltage **DC110V**  
 Roping **2:1**  
 Work Duty **S5-40%**  
 Wrapping **Single wrap**  
 CTW **50%**  
 Encoder **SinCos, PPR-2048, Voltage-5Vdc**  
 Insulation Class **F**  
 Protection Grade **IP40**

## SAMPLE CONFIGURATION TABLE

Model	Capacity	Elevator Speed	Rated Output	Rated voltage	Rated current	Rated speed	Frequency	Sheave Diameter	Poles	Torque	Ropes	Groove Dist	Shaft Load	Weight
	[kg]	[m/s]	[kW]	[V]	[A]	[rpm]	[Hz]	[mm]	[2p]	[Nm]		[mm]	[kg]	[kg]
<b>SGI 08-100-B</b>	544	1.00	3.52	360	11.5	160	21.3	240	16	210	4-Φ8	12	1,800	120

## DIMENSIONS

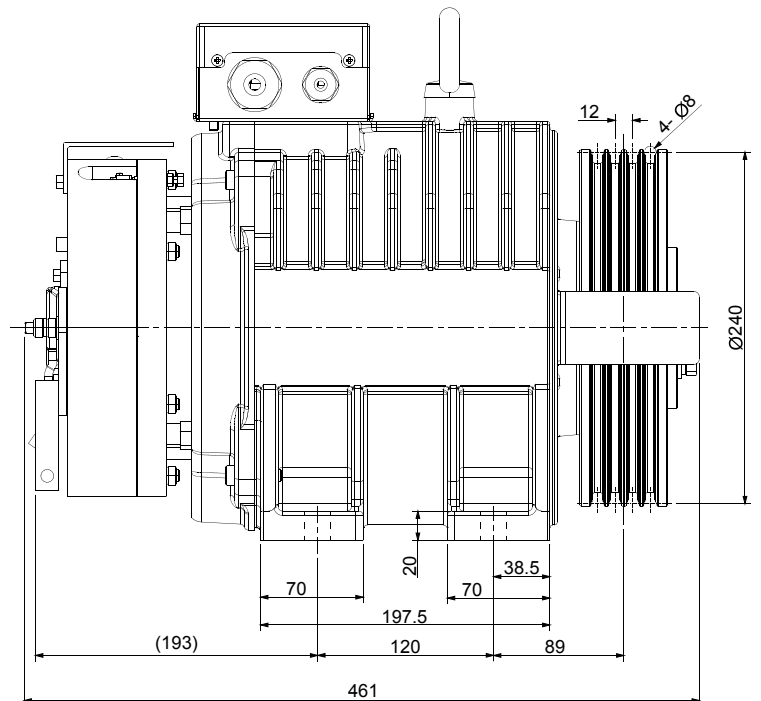
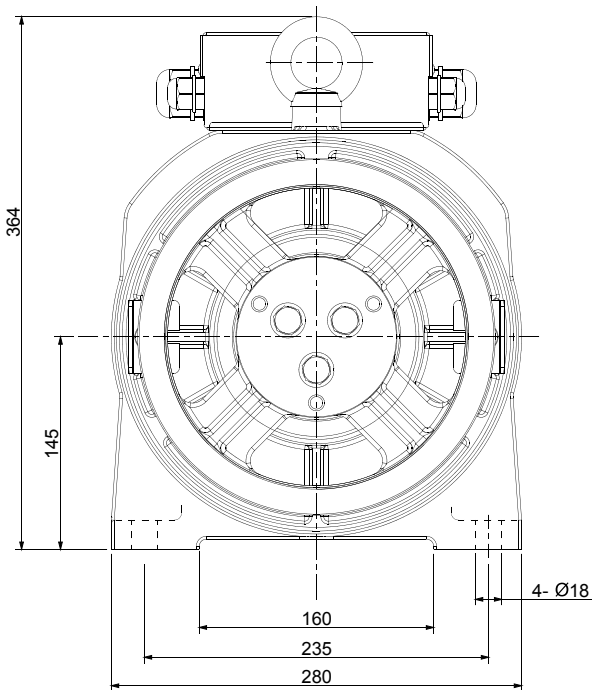

# SGI08-B



Sheave Diameter **320 mm**  
 Brake Torque **2x400 Nm**  
 Brake Voltage **DC110V**  
 Roping **2:1**  
 Work Duty **S5-40%**  
 Wrapping **Single wrap**  
 CTW **50%**  
 Encoder **SinCos, PPR-2048, Voltage-5Vdc**  
 Insulation Class **F**  
 Protection Grade **IP40**

## SAMPLE CONFIGURATION TABLE

Model	Capacity	Elevator Speed	Rated Output	Rated voltage	Rated current	Rated speed	Frequency	Sheave Diameter	Poles	Torque	Ropes	Groove Dist	Shaft Load	Weight
	[kg]	[m/s]	[kW]	[V]	[A]	[rpm]	[Hz]	[mm]	[2p]	[Nm]		[mm]	[kg]	[kg]
<b>SGI 08-100-B</b>	544	1.00	3.56	360	11.0	120	16.0	320	16	283	4-Φ8	12	1,800	135
<b>SGI 08-125-B</b>	544	1.25	4.42	360	15.5	149	19.9	320	16	283	4-Φ8	12	1,800	135
<b>SGI 08-150-B</b>	544	1.50	5.30	360	15.5	179	23.9	320	16	283	4-Φ8	12	1,800	135
<b>SGI 08-175-B</b>	544	1.75	6.20	360	18.0	209	34.8	320	16	283	4-Φ8	12	1,800	135

## DIMENSIONS

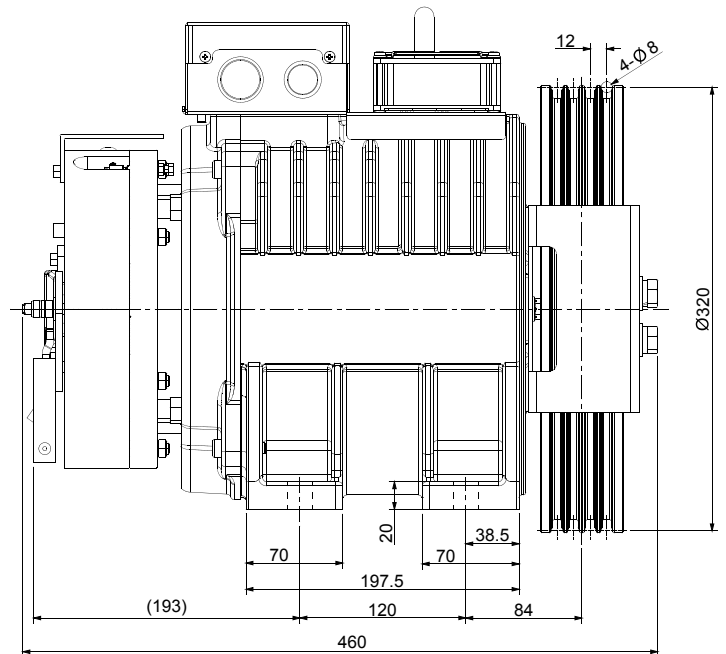
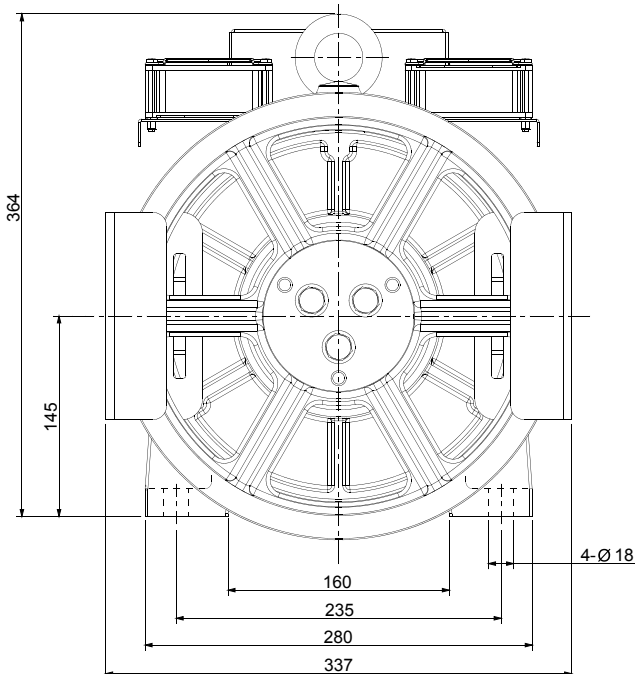

# SG110-N



Brake Torque **2x400 Nm**  
 Brake Voltage **DC110V**  
 Roping **2:1**  
 Work Duty **S5-40%**  
 Wrapping **Single wrap**  
 CTW **50%**  
 Encoder **SinCos, PPR-2048, Voltage-5Vdc**  
 Insulation Class **F**  
 Protection Grade **IP40**

## SAMPLE CONFIGURATION TABLE

Model	Capacity	Elevator Speed	Rated Output	Rated voltage	Rated current	Rated speed	Frequency	Sheave Diameter	Poles	Torque	Ropes	Groove Dist	Shaft Load	Weight
	[kg]	[m/s]	[kW]	[V]	[A]	[rpm]	[Hz]	[mm]	[2p]	[Nm]		[mm]	[kg]	[kg]
<b>SGI 10-100-N</b>	680	1.00	4.59	360	13.0	120	20.0	320	20	365	6-Φ8	12	2,000	155
<b>SGI 10-125-N</b>	680	1.25	5.70	360	17.7	149	24.8	320	20	365	6-Φ8	12	2,000	155
<b>SGI 10-150-N</b>	680	1.50	6.84	360	17.7	179	29.8	320	20	365	6-Φ8	12	2,000	155
<b>SGI 10-175-N</b>	680	1.75	8.03	360	22.0	209	34.8	320	20	365	6-Φ8	12	2,000	155

## DIMENSIONS

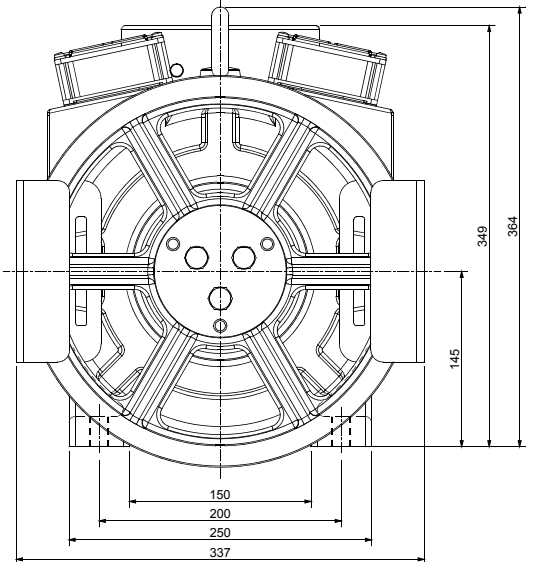
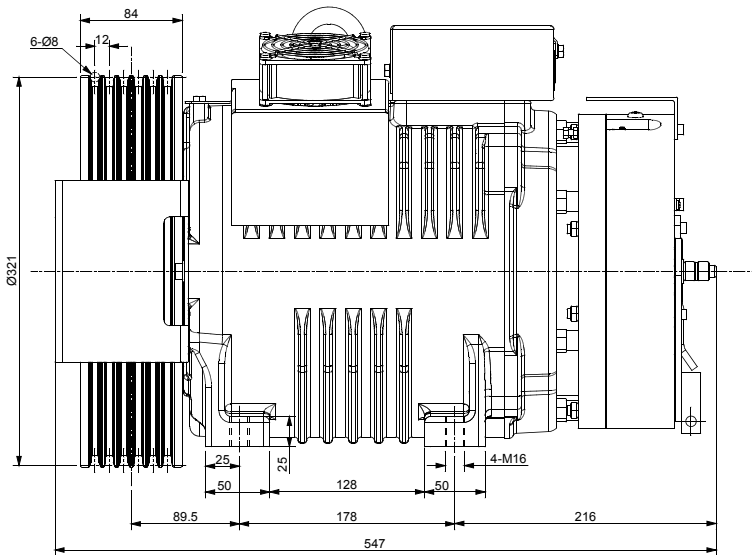

# SGI13-N



Brake Torque **2x600 Nm**  
 Brake Voltage **DC110V**  
 Roping **2:1**  
 Work Duty **S5-40%**  
 Wrapping **Single wrap**  
 CTW **50%**  
 Encoder **SinCos, PPR-2048, Voltage-5Vdc**  
 Insulation Class **F**  
 Protection Grade **IP40**

## SAMPLE CONFIGURATION TABLE

Model	Capacity	Elevator Speed	Rated Output	Rated voltage	Rated current	Rated speed	Frequency	Sheave Diameter	Poles	Torque	Ropes	Groove Dist	Shaft Load	Weight
	[kg]	[m/s]	[kW]	[V]	[A]	[rpm]	[Hz]	[mm]	[2p]	[Nm]		[mm]	[kg]	[kg]
<b>SGI 13-100-N</b>	884	1.00	5.71	360	17.8	120	20.0	320	20	454	6-Φ8	12	2,500	205
<b>SGI 13-125-N</b>	884	1.25	7.08	360	23.4	149	24.8	320	20	454	6-Φ8	12	2,500	205
<b>SGI 13-150-N</b>	884	1.50	8.51	360	23.4	179	29.8	320	20	454	6-Φ8	12	2,500	205
<b>SGI 13-175-N</b>	884	1.75	9.94	360	26.6	209	34.8	320	20	454	6-Φ8	12	2,500	205

## DIMENSIONS

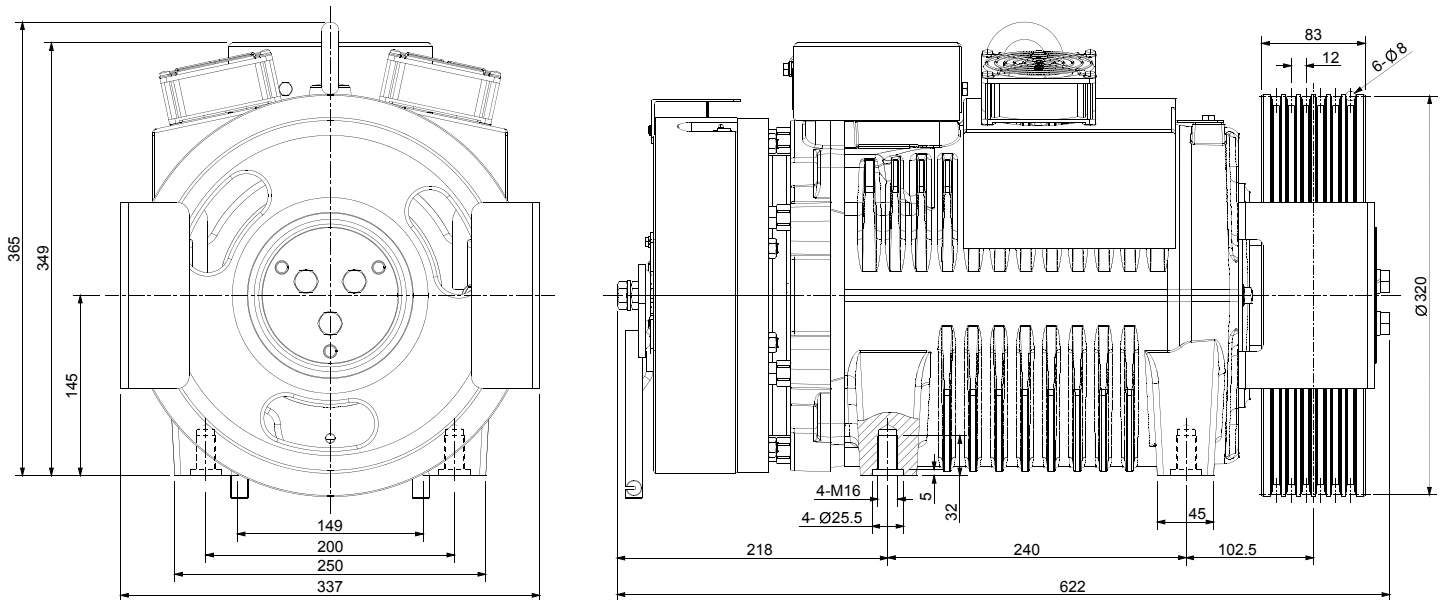



# SGI15-N

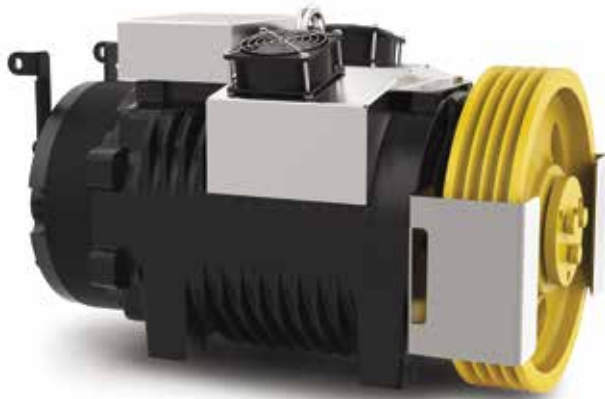

Brake Torque **2x600 Nm**  
 Brake Voltage **DC110V**  
 Roping **2:1**  
 Work Duty **S5-40%**  
 Wrapping **Single wrap**  
 CTW **50%**  
 Encoder **SinCos, PPR-2048, Voltage-5Vdc**  
 Insulation Class **F**  
 Protection Grade **IP40**

## SAMPLE CONFIGURATION TABLE

Model	Capacity	Elevator Speed	Rated Output	Rated voltage	Rated current	Rated speed	Frequency	Sheave Diameter	Poles	Torque	Ropes	Groove Dist	Shaft Load	Weight
	[kg]	[m/s]	[kW]	[V]	[A]	[rpm]	[Hz]	[mm]	[2p]	[Nm]		[mm]	[kg]	[kg]
<b>SGI 15-100-N</b>	1,020	1.00	6.22	360	18.6	120	20.0	320	20	495	6-Φ8	12	3,000	205
<b>SGI 15-125-N</b>	1,020	1.25	7.72	360	25.0	149	24.8	320	20	495	6-Φ8	12	3,000	205
<b>SGI 15-150-N</b>	1,020	1.50	9.28	360	31.5	179	29.8	320	20	495	6-Φ8	12	3,000	205
<b>SGI 15-175-N</b>	1,020	1.75	10.83	360	31.5	209	34.8	320	20	495	6-Φ8	12	2,500	205

## DIMENSIONS

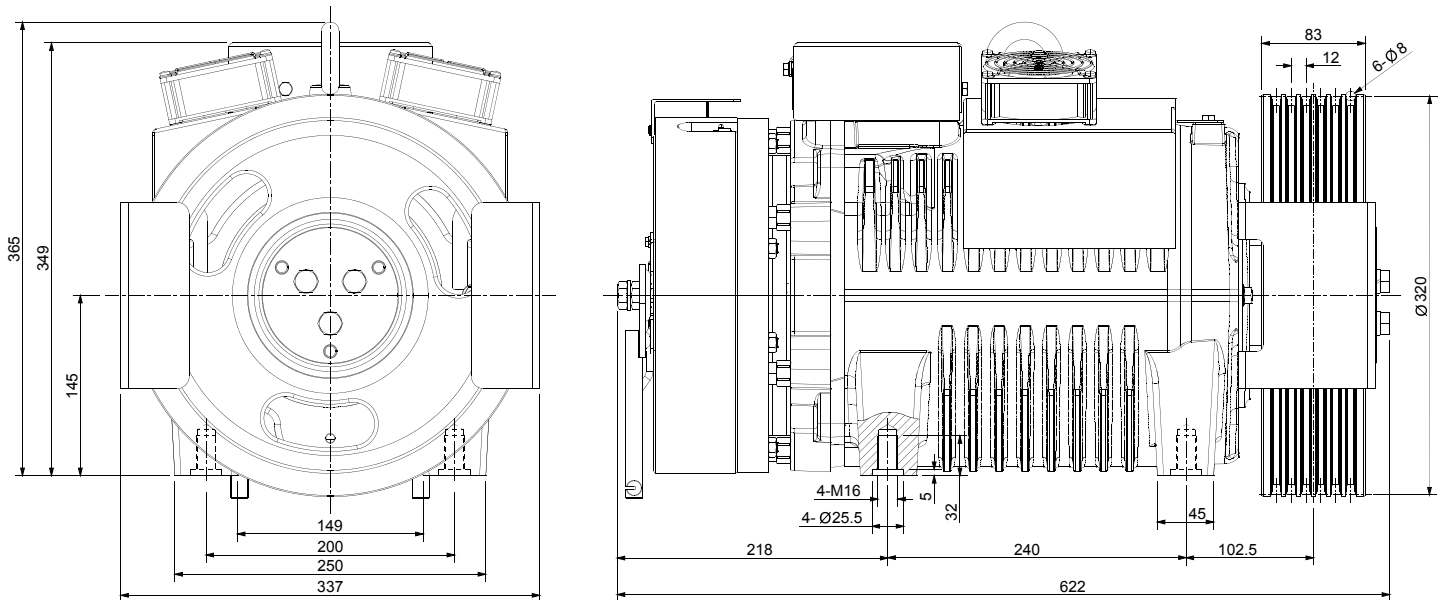

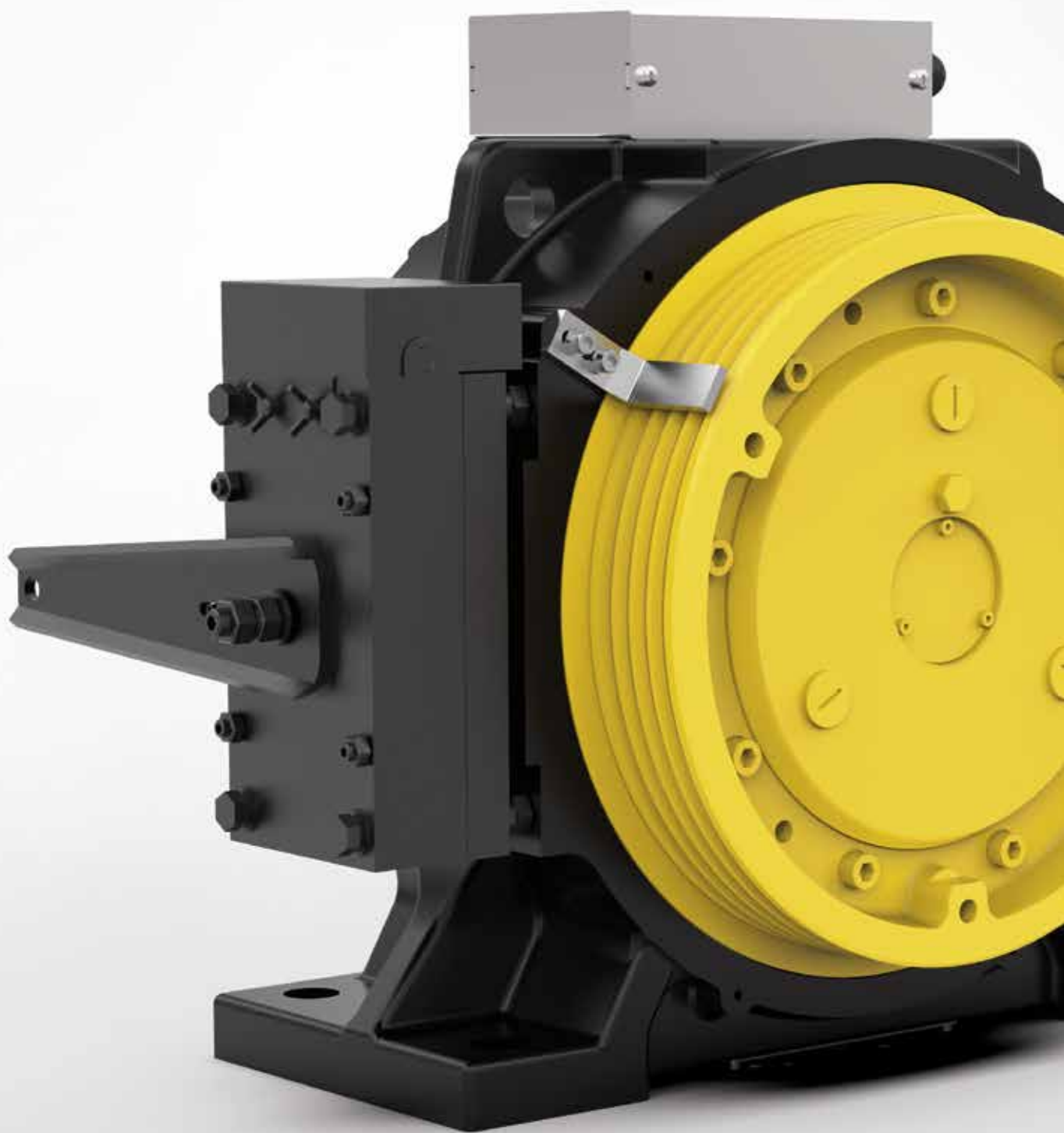

# “GEARLESS SGP”

<b>SGP06</b>	p.20
<b>SGP06-200</b>	p.21
<b>SGP08</b>	p.22
<b>SGP08-200</b>	p.23
<b>SGP10</b>	p.24
<b>SGP13</b>	p.25
<b>SGP16</b>	p.26
<b>SGP16</b>	p.27
<b>SGP20</b>	p.28
<b>SGP24</b>	p.29
<b>SGP26</b>	p.30



# SGP06



Brake Torque **2x340 Nm**  
 Brake Voltage **DC110V**  
 Roping **2:1**  
 Work Duty **S5-40%180 starts per hour**  
 Wrapping **Single wrap**  
 CTW **46%~50%**  
 Insulation Class **F**  
 Protection Grade **IP40**  
 Elevator Application **MRO, MRL**  
 Groove Profile **"Undercut U" ANGLE  $\beta=90^\circ$   $\gamma=30^\circ$**

## CONFIGURATION TABLE

Model	Capacity	Elevator Speed	Rated Output	Rated Voltage	Rated Current	Rated Speed	Frequency	Sheave Diameter	Poles	Torque	Ropes	Groove Dist.	Shaft Load	Weight
	kg	m/s	kW	V	A	rpm	Hz	mm	2p	Nm		mm	kg	kg
<b>SGP06-100</b>	408	1.00	2.5	360	6.5	116	23.2	330	24	207	4- $\Phi$ 8	12	1,600	180
<b>SGP06-150</b>	408	1.50	3.8	360	10.5	174	34.8	330	24	207	4- $\Phi$ 8	12	1,600	180
<b>SGP06-175</b>	408	1.75	4.4	360	10.5	203	40.6	330	24	207	4- $\Phi$ 8	12	1,600	180

## DIMENSIONS

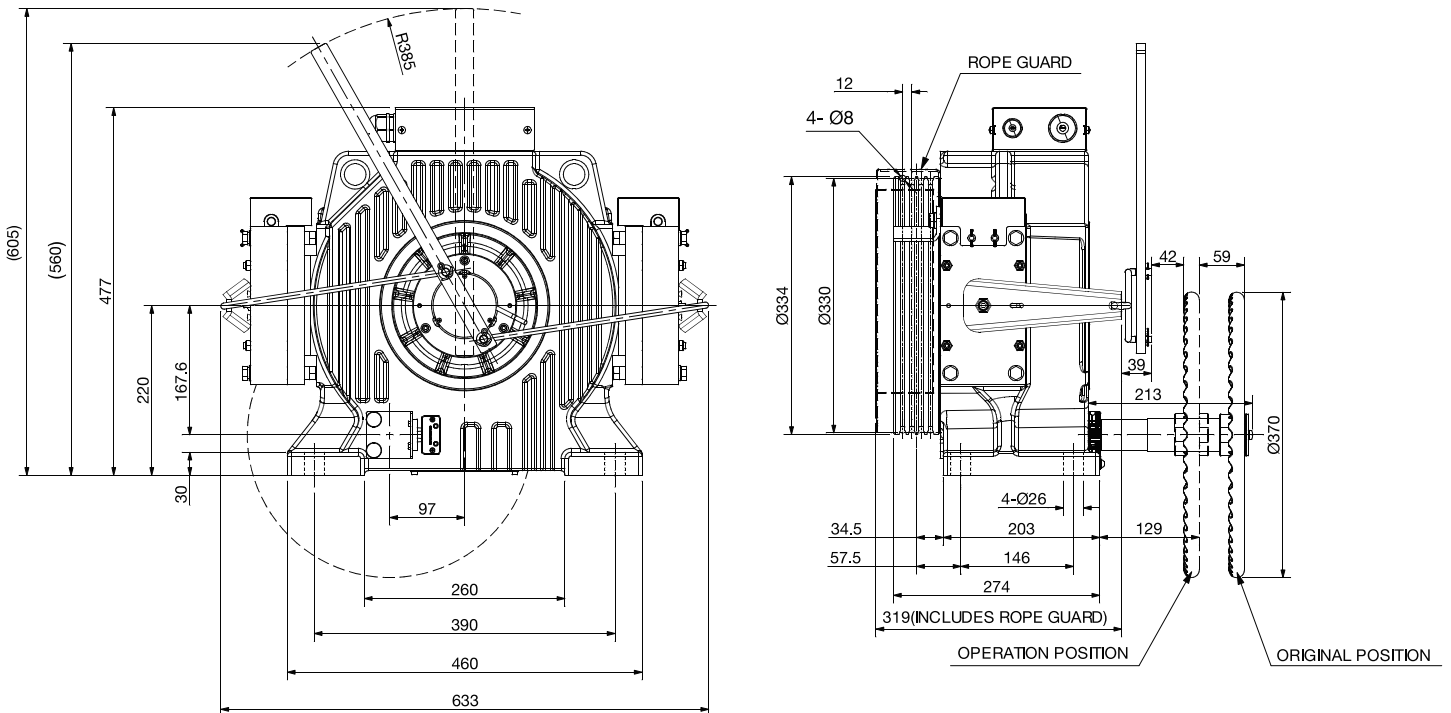

# SGP06-200



Brake Torque **2x530 Nm**  
 Brake Voltage **DC110V**  
 Roping **2:1**  
 Work Duty **S5-40%180 starts per hour**  
 Wrapping **Single wrap**  
 CTW **46%~50%**  
 Insulation Class **F**  
 Protection Grade **IP40**  
 Elevator Application **MRO, MRL**  
 Groove Profile **"Undercut U" ANGLE  $\beta=95^\circ$   $\gamma=30^\circ$**

## CONFIGURATION TABLE

Model	Capacity	Elevator Speed	Rated Output	Rated Voltage	Rated Current	Rated Speed	Frequency	Sheave Diameter	Poles	Torque	Ropes	Groove Dist.	Shaft Load	Weight
	kg	m/s	kW	V	A	rpm	Hz	mm	2p	Nm		mm	kg	kg
<b>SGP06-200</b>	408	2.00	5.1	360	13.0	191	50.9	400	32	255	4- $\Phi$ 10	16	2,000	245

## DIMENSIONS

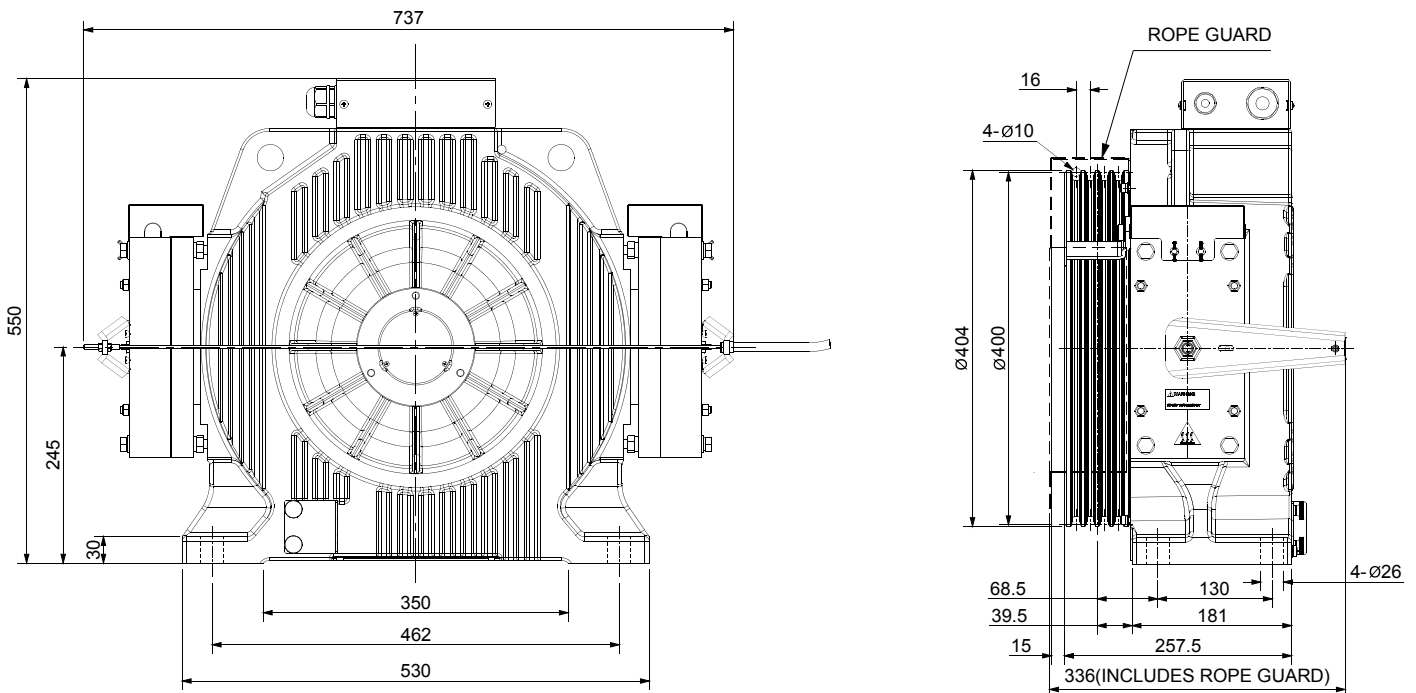

# SGP08



Brake Torque **2x340 Nm**  
 Brake Voltage **DC110V**  
 Roping **2:1**  
 Work Duty **S5-40%180 starts per hour**  
 Wrapping **Single wrap**  
 CTW **46%~50%**  
 Insulation Class **F**  
 Protection Grade **IP40**  
 Elevator Application **MRO, MRL**  
 Groove Profile **"Undercut U" ANGLE  $\beta=90^\circ$   $\gamma=30^\circ$**

## CONFIGURATION TABLE

Model	Capacity	Elevator Speed	Rated Output	Rated Voltage	Rated Current	Rated Speed	Frequency	Sheave Diameter	Poles	Torque	Ropes	Groove Dist.	Shaft Load	Weight
	kg	m/s	kW	V	A	rpm	Hz	mm	2p	Nm		mm	kg	kg
<b>SGP08-100</b>	544	1.00	3.3	360	8.5	116	23.2	330	24	275	4- $\Phi$ 8	12	1,600	190
<b>SGP08-150</b>	544	1.50	5.0	360	13.0	174	34.8	330	24	275	4- $\Phi$ 8	12	1,600	190
<b>SGP08-175</b>	544	1.75	5.8	360	13.0	203	40.6	330	24	275	4- $\Phi$ 8	12	1,600	190

## DIMENSIONS

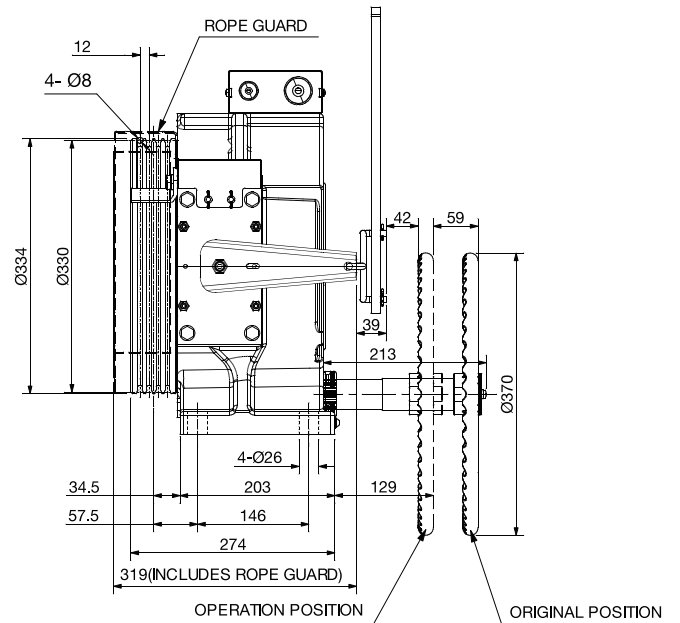
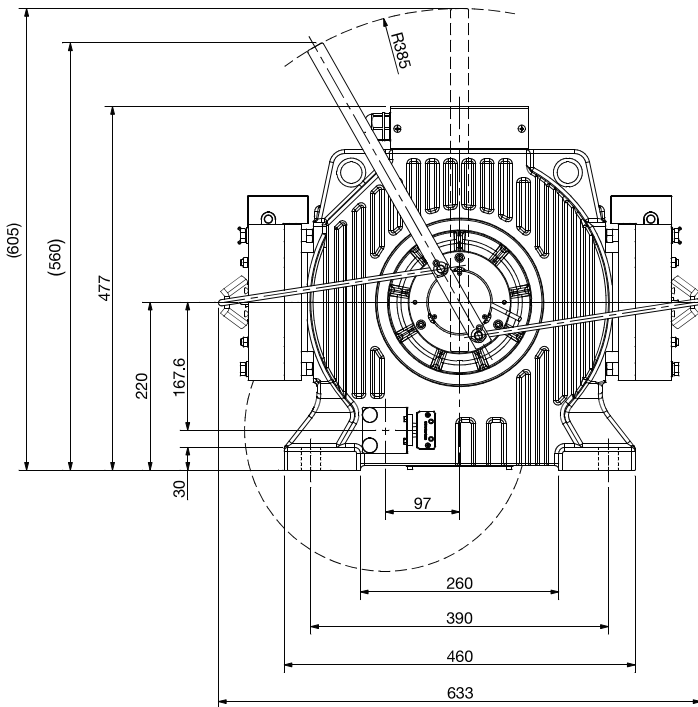

# SGP08-200



Brake Torque **2x530 Nm**  
 Brake Voltage **DC110V**  
 Roping **2:1**  
 Work Duty **S5-40%180 starts per hour**  
 Wrapping **Single wrap**  
 CTW **46%~50%**  
 Insulation Class **F**  
 Protection Grade **IP40**  
 Elevator Application **MRO, MRL**  
 Groove Profile **"Undercut U" ANGLE  $\beta=95^\circ$   $\gamma=30^\circ$**

## CONFIGURATION TABLE

Model	Capacity	Elevator Speed	Rated Output	Rated Voltage	Rated Current	Rated Speed	Frequency	Sheave Diameter	Poles	Torque	Ropes	Groove Dist.	Shaft Load	Weight
	kg	m/s	kW	V	A	rpm	Hz	mm	2p	Nm		mm	kg	kg
<b>SGP08-200</b>	544	2.00	6.8	360	17.0	191	50.9	400	32	340	4- $\Phi$ 10	16	2,000	245

## DIMENSIONS

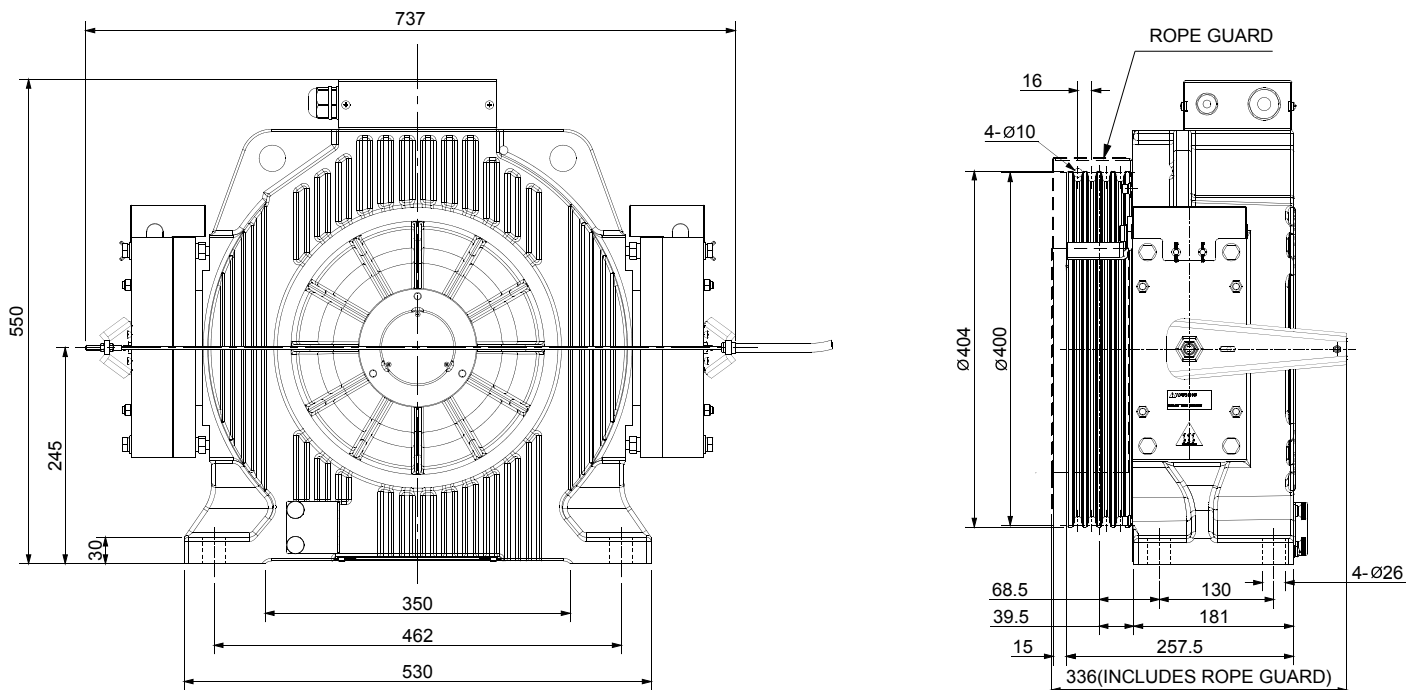

# SGP10



Brake Torque **2x530 Nm**  
 Brake Voltage **DC110V**  
 Roping **2:1**  
 Work Duty **S5-40%180 starts per hour**  
 Wrapping **Single wrap**  
 CTW **46%~50%**.  
 Insulation Class **F**  
 Protection Grade **IP40**  
 Elevator Application **MRO, MRL**  
 Groove Profile **"Undercut U" ANGLE  $\beta=95^\circ$   $\gamma=30^\circ$**

## CONFIGURATION TABLE

Model	Capacity	Elevator Speed	Rated Output	Rated Voltage	Rated Current	Rated Speed	Frequency	Sheave Diameter	Poles	Torque	Ropes	Groove Dist.	Shaft Load	Weight
	kg	m/s	kW	V	A	rpm	Hz	mm	2p	Nm		mm	kg	kg
<b>SGP10-100</b>	680	1.00	4.2	360	10.5	95	25.3	400	32	419	4- $\Phi$ 10	16	2,000	245
<b>SGP10-150</b>	680	1.50	6.3	360	17.0	143	38.1	400	32	419	4- $\Phi$ 10	16	2,000	245
<b>SGP10-175</b>	680	1.75	7.3	360	17.0	167	44.5	400	32	419	4- $\Phi$ 10	16	2,000	245
<b>SGP10-200</b>	680	2.00	8.5	360	24.5	191	50.9	400	32	425	4- $\Phi$ 10	16	2,000	245

## DIMENSIONS

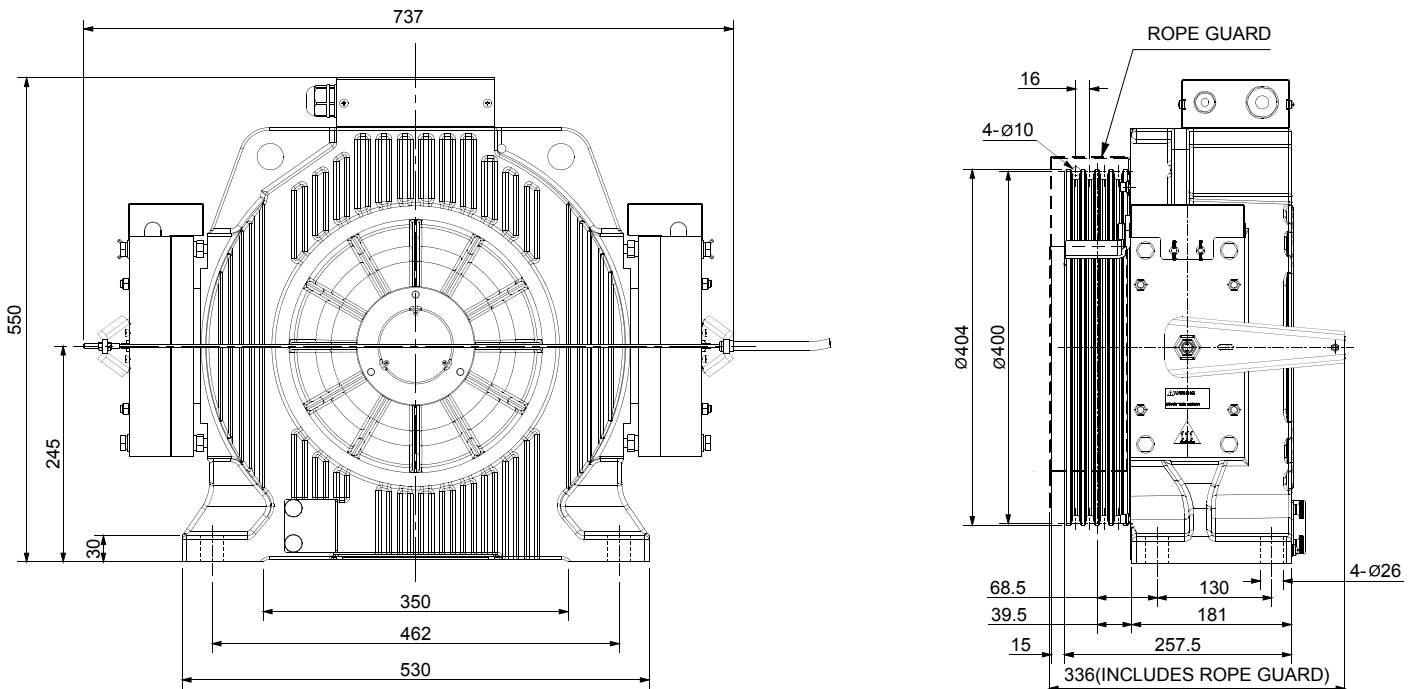



# SGP13



Brake Torque **2x840 Nm**  
 Brake Voltage **DC110V**  
 Roping **2:1**  
 Work Duty **S5-40%180 starts per hour**  
 Wrapping **Single wrap**  
 CTW **46%~50%**.  
 Insulation Class **F**  
 Protection Grade **IP40**  
 Elevator Application **MRO, MRL**  
 Groove Profile **"Undercut U" ANGLE  $\beta=95^\circ$   $\gamma=30^\circ$**

## CONFIGURATION TABLE

Model	Capacity	Elevator Speed	Rated Output	Rated Voltage	Rated Current	Rated Speed	Frequency	Sheave Diameter	Poles	Torque	Ropes	Groove Dist.	Shaft Load	Weight
	kg	m/s	kW	V	A	rpm	Hz	mm	2p	Nm	5- $\Phi$ 10	mm	kg	kg
<b>SGP13-100</b>	884	1.00	5.4	360	12.5	95	25.3	400	32	544	5- $\Phi$ 10	16	3,000	310
<b>SGP13-150</b>	884	1.50	8.1	360	21.0	143	38.1	400	32	544	5- $\Phi$ 10	16	3,000	310
<b>SGP13-175</b>	884	1.75	9.5	360	21.0	167	44.5	400	32	544	5- $\Phi$ 10	16	3,000	310
<b>SGP13-200</b>	884	2.00	10.9	360	25.0	191	50.9	400	32	544	5- $\Phi$ 10	16	3,000	310
<b>SGP13-250</b>	884	2.50	13.6	360	30.0	239	63.7	400	32	544	5- $\Phi$ 10	16	3,000	310

## DIMENSIONS

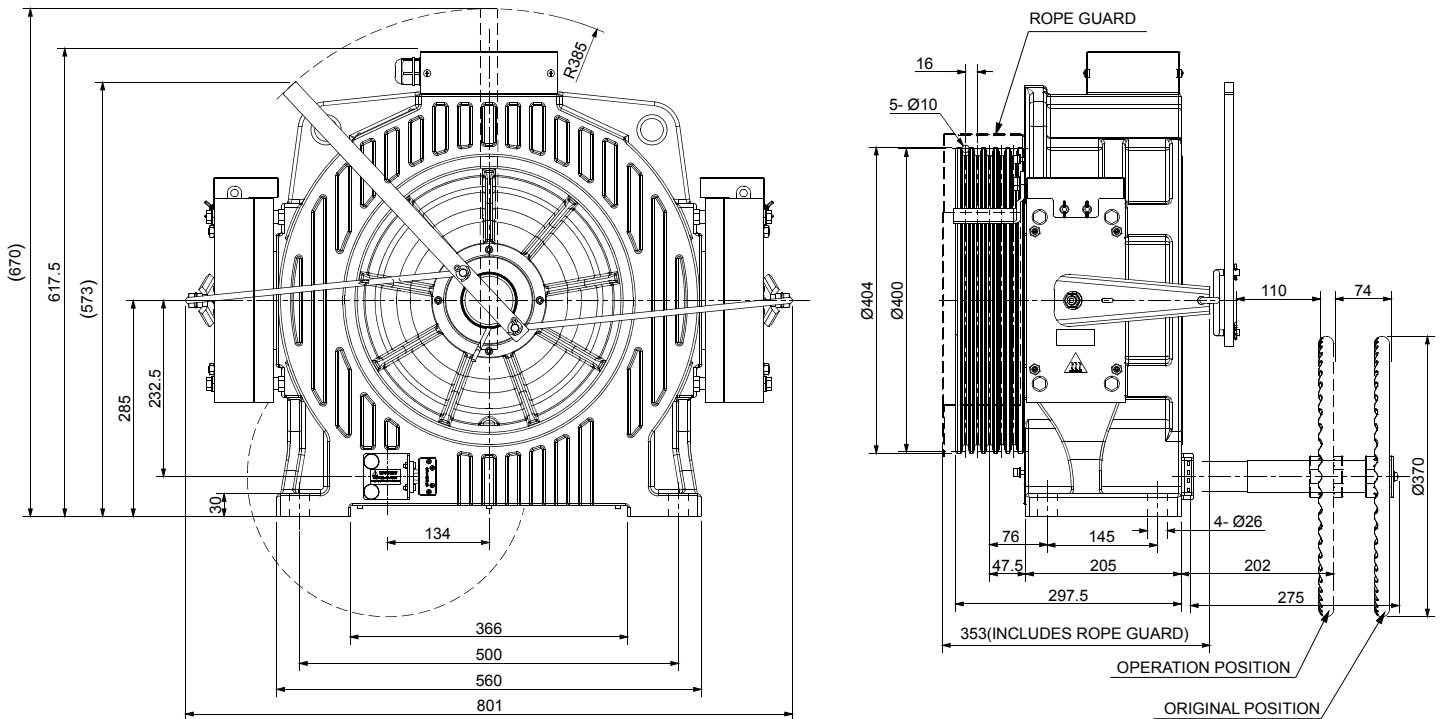

# SGP16



Brake Torque **2x840 Nm**  
 Brake Voltage **DC110V**  
 Roping **2:1**  
 Work Duty **S5-40%180 starts per hour**  
 Wrapping **Single wrap**  
 CTW **46%~50%**  
 Insulation Class **F**  
 Protection Grade **IP40**  
 Elevator Application **MRO, MRL**  
 Groove Profile **"Undercut U" ANGLE  $\beta=95^\circ$   $\gamma=30^\circ$**

## CONFIGURATION TABLE

Model	Capacity	Elevator Speed	Rated Output	Rated Voltage	Rated Current	Rated Speed	Frequency	Sheave Diameter	Poles	Torque	Ropes	Groove Dist.	Shaft Load	Weight
	kg	m/s	kW	V	A	rpm	Hz	mm	2p	Nm		mm	kg	kg
<b>SGP16-100</b>	1,088	1.00	6.7	360	16.0	95	25.3	400	32	669	5- $\Phi$ 10	16	3,000	315
<b>SGP16-150</b>	1,088	1.50	10.0	360	26.5	143	38.1	400	32	669	5- $\Phi$ 10	16	3,000	315
<b>SGP16-175</b>	1,088	1.75	11.7	360	26.5	167	44.5	400	32	669	5- $\Phi$ 10	16	3,000	315

## DIMENSIONS

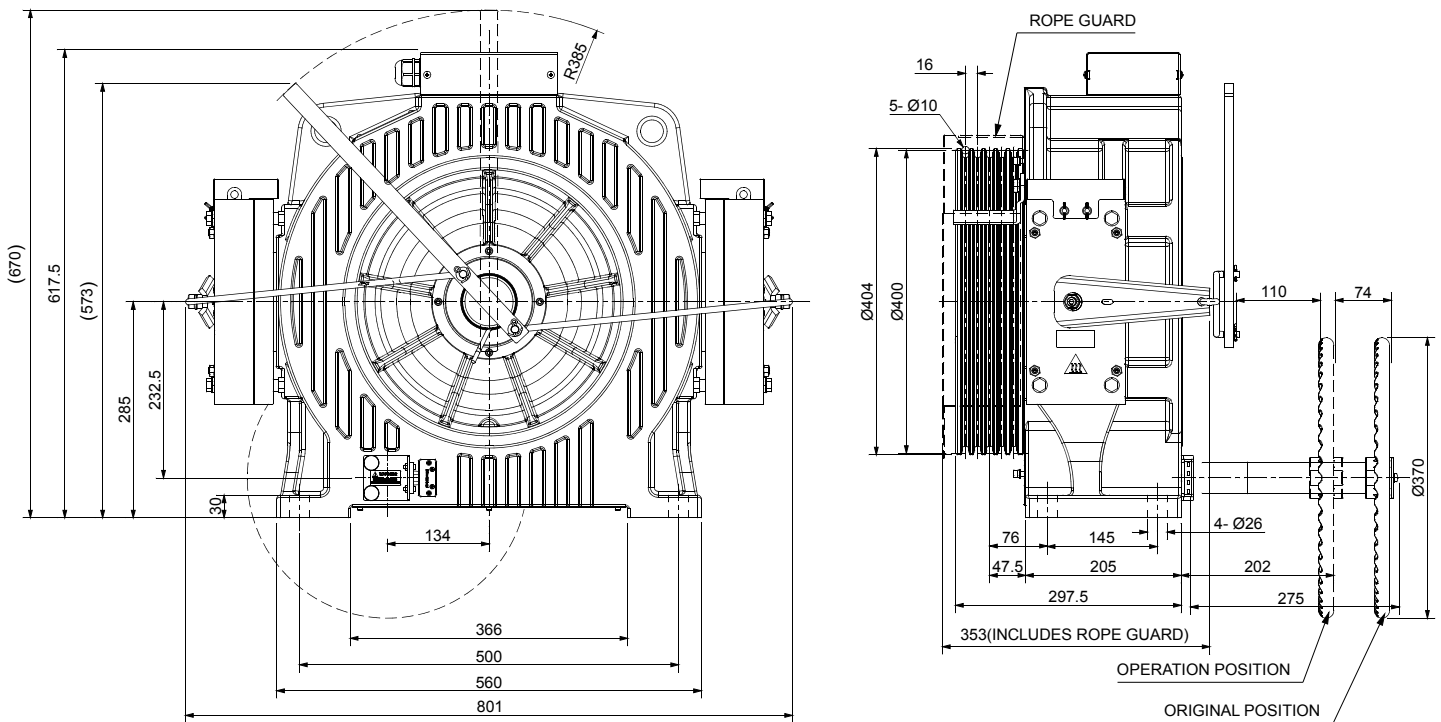

# SGP16



Brake Torque **2x840 Nm**  
 Brake Voltage **DC110V**  
 Roping **2:1**  
 Work Duty **S5-40%180 starts per hour**  
 Wrapping **Single wrap**  
 CTW **46%~50%**  
 Insulation Class **F**  
 Protection Grade **IP40**  
 Elevator Application **MRO**  
 Groove Profile **"Undercut U" ANGLE  $\beta=95^\circ$   $\gamma=30^\circ$**

## CONFIGURATION TABLE

Model	Capacity	Elevator Speed	Rated Output	Rated Voltage	Rated Current	Rated Speed	Frequency	Sheave Diameter	Poles	Torque	Ropes	Groove Dist.	Shaft Load	Weight
	kg	m/s	kW	V	A	rpm	Hz	mm	2p	Nm		mm	kg	kg
<b>SGP16-200</b>	1,088	2.00	13.4	360	37.0	191	50.9	400	32	671	6- $\Phi$ 10	16	3,000	315
<b>SGP16-250</b>	1,088	2.50	16.8	360	37.0	239	63.7	400	32	671	6- $\Phi$ 10	16	3,000	315

For MRL application, manual remote release kit will not be provided with machine, customer need to prepare electrical power for brake remote release function.

## DIMENSIONS

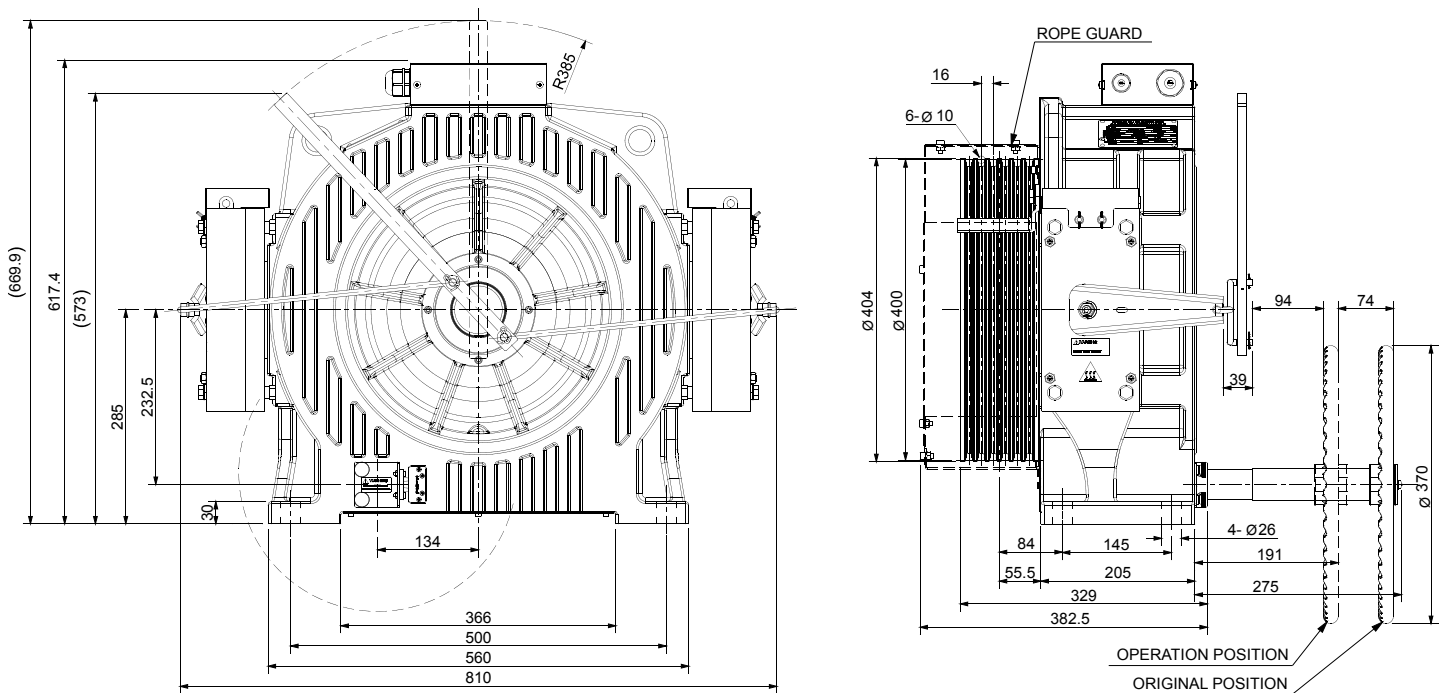

# SGP20



Brake Torque **2x1200 Nm**  
 Brake Voltage **DC110V**  
 Roping **2:1**  
 Work Duty **S5-40%180 starts per hour**  
 Wrapping **Single wrap**  
 CTW **46%~50%**.  
 Insulation Class **F**  
 Protection Grade **IP40**  
 Elevator Application **MRO**  
 Groove Profile **"Undercut U" ANGLE  $\beta=95^\circ$   $\gamma=30^\circ$**

## CONFIGURATION TABLE

Model	Capacity	Elevator Speed	Rated Output	Rated Voltage	Rated Current	Rated Speed	Frequency	Sheave Diameter	Poles	Torque	Ropes	Groove Dist.	Shaft Load	Weight
	kg	m/s	kW	V	A	rpm	Hz	mm	2p	Nm		mm	kg	kg
<b>SGP20-100</b>	1,360	1.00	9.2	360	25.5	95	25.3	400	32	925	8- $\Phi$ 10	16	4,500	475
<b>SGP20-125</b>	1,360	1.25	11.5	360	29.5	119	31.7	400	32	925	8- $\Phi$ 10	16	4,500	475
<b>SGP20-150</b>	1,360	1.50	13.9	360	38.5	143	38.1	400	32	925	8- $\Phi$ 10	16	4,500	475
<b>SGP20-175</b>	1,360	1.75	16.2	360	38.5	167	44.5	400	32	925	8- $\Phi$ 10	16	4,500	475
<b>SGP20-200</b>	1,360	2.00	18.5	360	44.5	191	50.9	400	32	925	8- $\Phi$ 10	16	4,500	475
<b>SGP20-250</b>	1,360	2.50	23.2	360	54.0	239	63.7	400	32	925	8- $\Phi$ 10	16	4,500	475

For MRL application, manual remote release kit will not be provided with machine, customer need to prepare electrical power for brake remote release function.

## DIMENSIONS

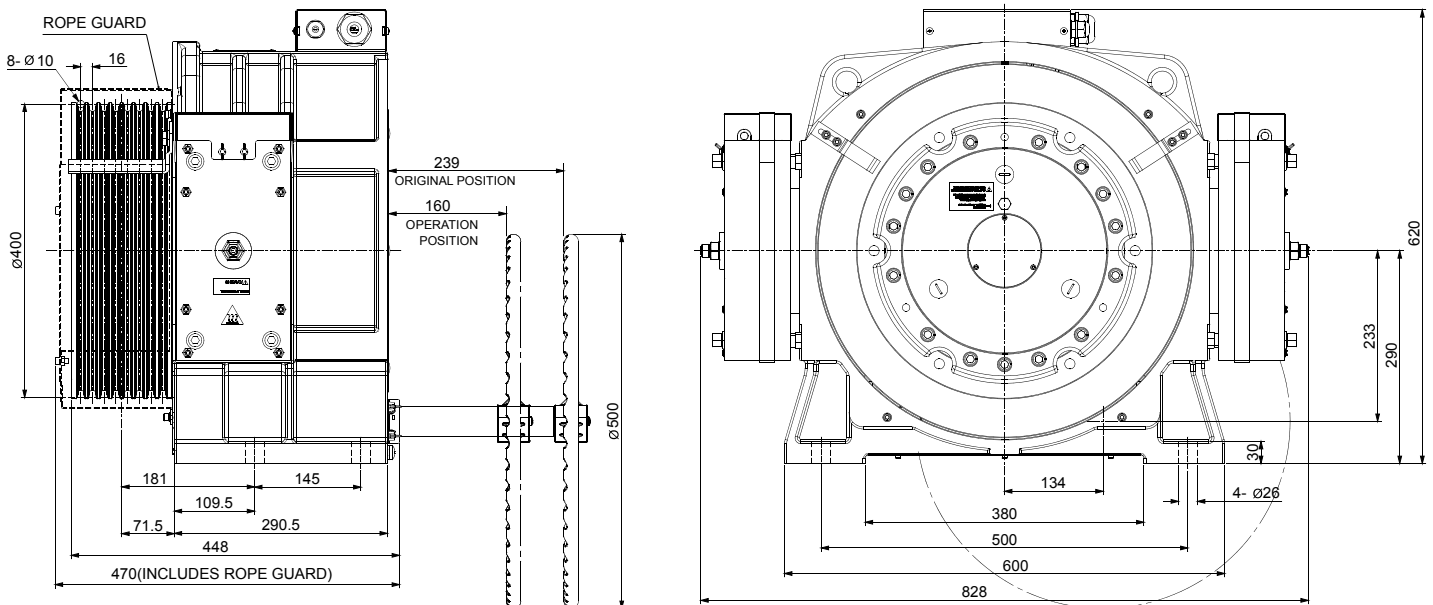

# SGP24



Brake Torque **2x1500 Nm**  
 Brake Voltage **DC110V**  
 Roping **2:1**  
 Work Duty **S5-40%180 starts per hour**  
 Wrapping **Single wrap**  
 CTW **46%~50%**  
 Insulation Class **F**  
 Protection Grade **IP40**  
 Elevator Application **MRO**  
 Groove Profile **"Undercut U" ANGLE  $\beta=95^\circ$   $\gamma=30^\circ$**

## CONFIGURATION TABLE

Model	Capacity	Elevator Speed	Rated Output	Rated Voltage	Rated Current	Rated Speed	Frequency	Sheave Diameter	Poles	Torque	Ropes	Groove Dist.	Shaft Load	Weight
	kg	m/s	kW	V	A	rpm	Hz	mm	2p	Nm		mm	kg	kg
<b>SGP24-100</b>	1,632	1.00	10.7	360	28.5	95	25.3	400	32	1,070	8- $\Phi$ 10	16	4,500	490
<b>SGP24-125</b>	1,632	1.25	13.3	360	32.5	119	31.7	400	32	1,070	8- $\Phi$ 10	16	4,500	490
<b>SGP24-150</b>	1,632	1.50	16.0	360	44.5	143	38.1	400	32	1,070	8- $\Phi$ 10	16	4,500	490
<b>SGP24-175</b>	1,632	1.75	18.7	360	44.5	167	44.5	400	32	1,070	8- $\Phi$ 10	16	4,500	490
<b>SGP24-200</b>	1,632	2.00	21.4	360	51.5	191	50.9	400	32	1,070	8- $\Phi$ 10	16	4,500	490
<b>SGP24-250</b>	1,632	2.50	26.8	360	60.0	239	63.7	400	32	1,070	8- $\Phi$ 10	16	4,500	490

For MRL application, manual remote release kit will not be provided with machine, customer need to prepare electrical power for brake remote release function.

## DIMENSIONS

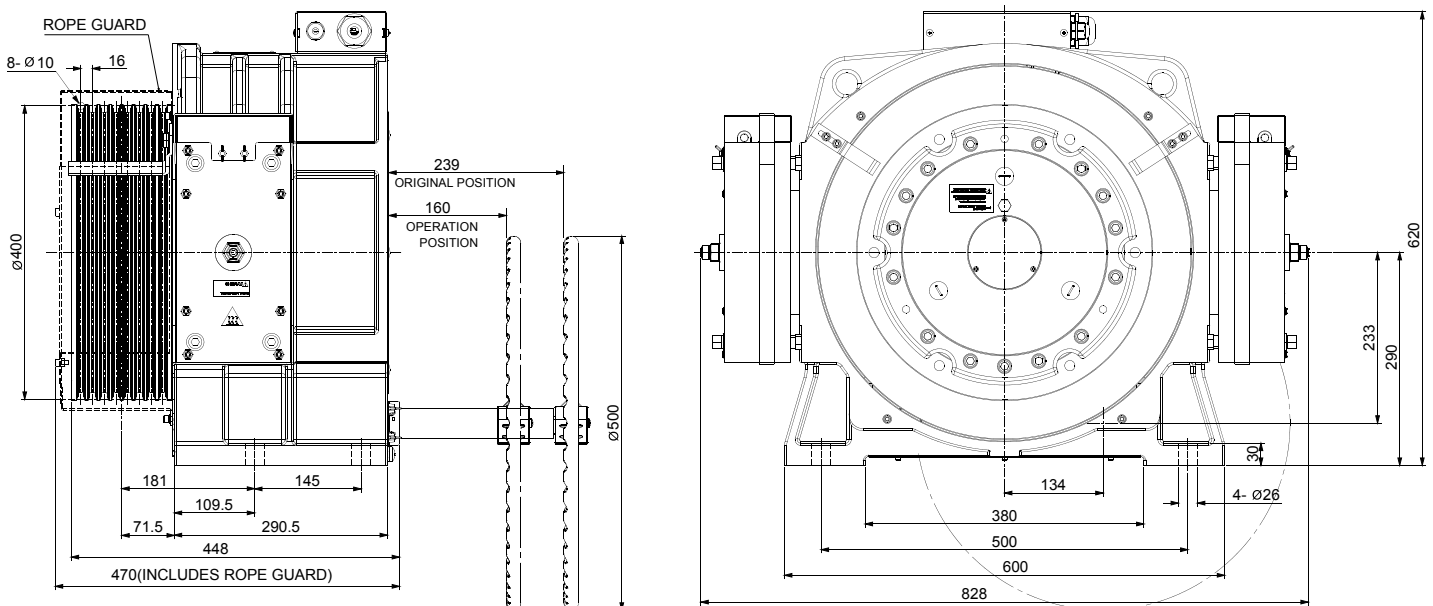

# SGP26



Brake Torque **2x1500 Nm**  
 Brake Voltage **DC110V**  
 Roping **2:1**  
 Work Duty **S5-40%180 starts per hour**  
 Wrapping **Single wrap**  
 CTW **46%~50%**  
 Insulation Class **F**  
 Protection Grade **IP40**  
 Elevator Application **MRO**  
 Groove Profile **"Undercut U" ANGLE  $\beta=95^\circ$   $\gamma=30^\circ$**

## CONFIGURATION TABLE

Model	Capacity	Elevator Speed	Rated Output	Rated Voltage	Rated Current	Rated Speed	Frequency	Sheave Diameter	Poles	Torque	Ropes	Groove Dist.	Shaft Load	Weight
	kg	m/s	kW	V	A	rpm	Hz	mm	2p	Nm		mm	kg	kg
<b>SGP26-100</b>	1,768	1.00	11.2	360	29.0	79	21.1	480	32	1,350	6- $\Phi$ 12	18	5,000	510
<b>SGP26-150</b>	1,768	1.50	16.8	360	47.5	119	31.7	480	32	1,350	6- $\Phi$ 12	18	5,000	510
<b>SGP26-175</b>	1,768	1.75	19.7	360	47.5	139	37.1	480	32	1,350	6- $\Phi$ 12	18	5,000	510

For MRL application, manual remote release kit will not be provided with machine, customer need to prepare electrical power for brake remote release function.

## DIMENSIONS

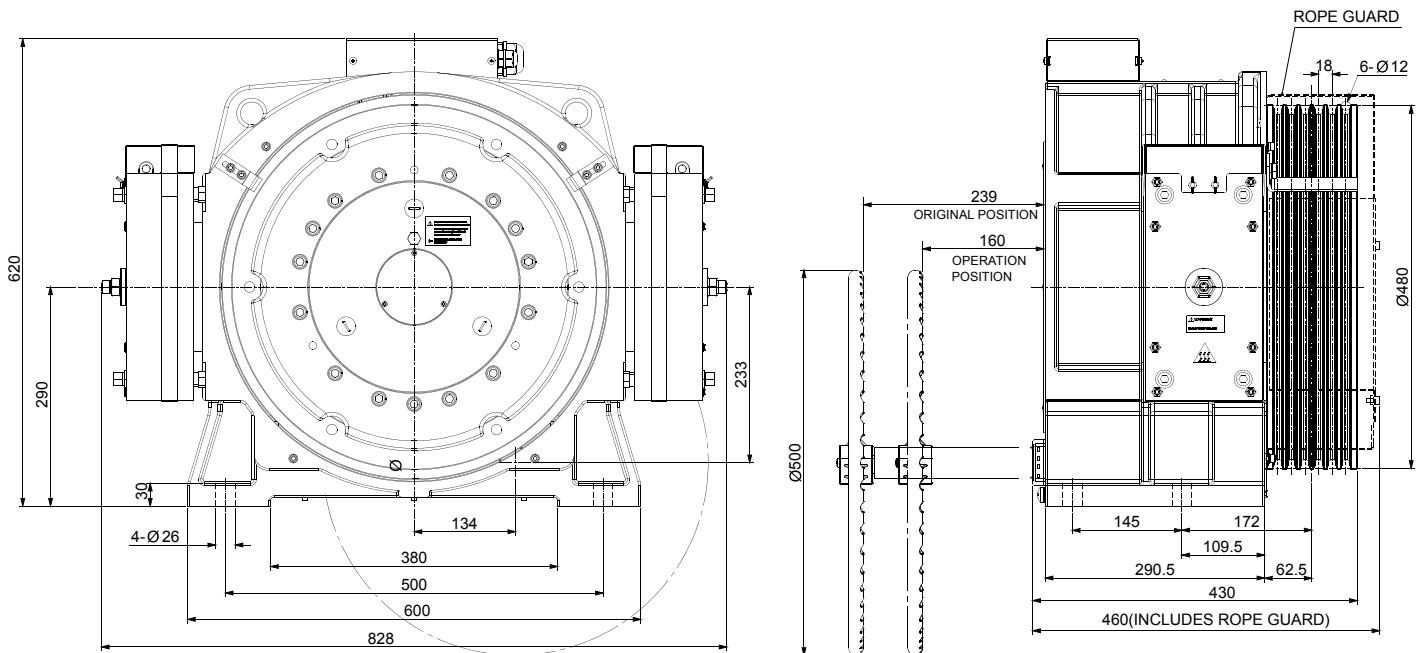





**SICOR INDIA**  
AN ELEVANTIS COMPANY

ORIGINALLY FROM ITALY  
PROUDLY MADE IN INDIA

**Sicor India Private Limited**

No.34, Survey No 94/7, 96/1, Nandhimedu Village Road, Santhavelur Village  
Sunguvachatram post, Sriperumbudur - Taluk, Kancheepuram District Chennai - 602 106  
Tamil Nadu - India

Phone +91-9962258111 · +91-7305095460 · sales@sicorindia.com

**[www.sicorindia.com](http://www.sicorindia.com)**